

Suspension Kit

HDG Beam Clamp Wall Kit



Polyplas Beam Clamp Wall Suspension Kits provide a secure engineered solution to swiftly secure a wide range of panels. Provide your panel thickness to Polyplas to attain the correct kit size.

- Rod length Available - 150 mm - 1.0 m
- Beam Clamp Available in M10 & M12
- Available in HDG, Zinc plate & Stainless Steel



Product Specification

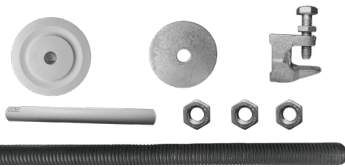

- Threaded Rod
- HDG Beam Clamp
- Galvanized Nut
- Plastic Crush Tube / Ferrule
- Mushroom Head

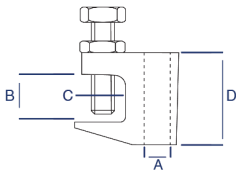

Measurements (mm)

Product Code	A	B	C	D
MC10: BC10	M10	21.5	27	42
MC12: BC12	M12	27.5	34	54

Application

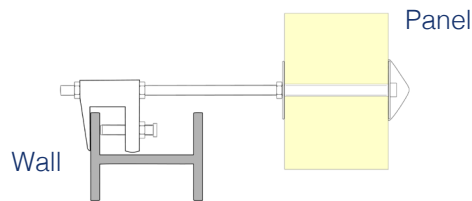

Product Variations

Product Code	Beam Clamp (MM)	Mushroom Head	Threaded Rod (MM)
WSK B 10	10	MH10 SS2	10
WASK B 12	12	MH12 SS2	12

Note: Mushroom Caps available in various colours and materials, speak to Polyplas to confirm best option.